

**CZL629**

[Date : 2010-02-14] Source : DONGGUAN SOUTH CHINA SEA ELECTRONIC CO.,LTD Read : 2913times



**Rated load (kg):** 50、100、150、200、300、350、500、750、1000

**Main features:** The product is made of alloy aluminum. It is hermetically sealed with glue to IP65, surface anodized and anti-corrosion, integral structure and easy installation. The product is suit for electronic top scale, floor scale and other weighing equipment.

**Parameters:**

Precision : C2/C3

Comprehensive error(%F.S) :  $\pm 0.02/\pm 0.017$

Rated output(mv/v) :  $2.0\pm 0.2$

Creep(%F.S/30min) :  $\pm 0.02/\pm 0.017$

Zero balance(%F.S) :  $\pm 2.0$

Input resistance( $\Omega$ ) :  $405\pm 10$

Output resistance( $\Omega$ ) :  $350\pm 3$

Insulation resistance(M $\Omega$ ) :  $\geq 5000(100VDC)$

Temp. effect on span(%F.S/10°C):  $\pm 0.02/\pm 0.014$

Temp. effect on zero(%F.S/10°C) :  $\pm 0.03/\pm 0.017$

Compensated temp. range(°C) : -10 ~ +40

Use temp. range(°C) : -20 ~ +60

Excitation voltage(V) : 9 ~ 12(DC)

Safe overload (%F.S) : 120

Ultimate overload (%F.S) : 150

Defend grade : IP65

Installation size (mm):

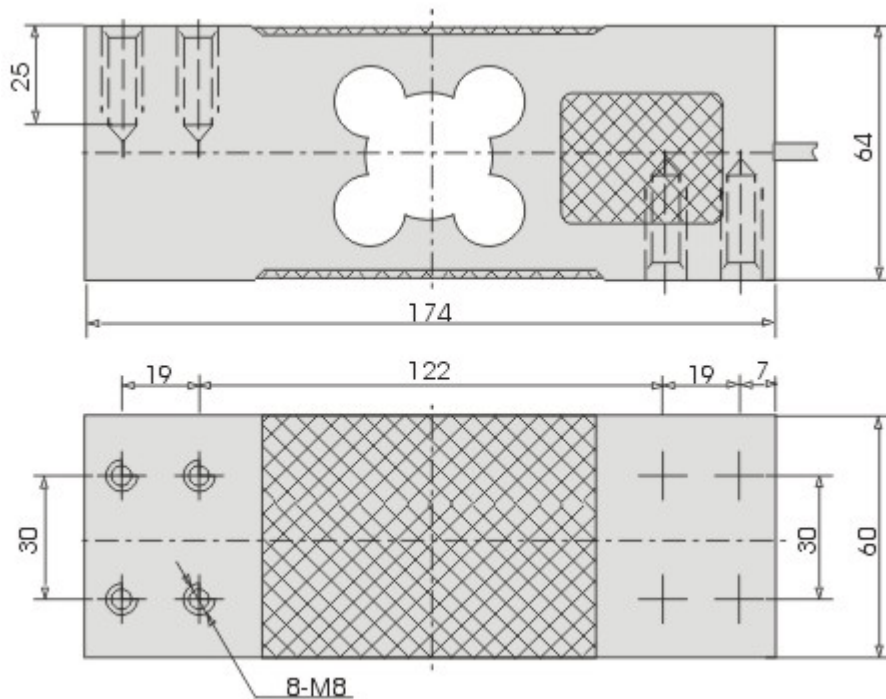

Wiring schematic diagram:

Red: Input ( + )      White: Output ( - )  
 Black: Input ( - )      Green: Output ( + )

Notes : It used 4-core shielded cable( $\phi 5 \times 3000$ mm)

Load instruction:

