

## "RC" / Column type with Spherical mounting plate



### Features

- High reliability. For versatile applications.
- An abundant delivery achievement. Low cost.
- Equipped with a spherical base (also with a dropping-out prevention cap).
- A wide range of capacities (10kN to 5MN).
- Accuracy class: 0.15%.

Related products : [RCE](#) / [RCU](#)...

### Appearance Dimensions

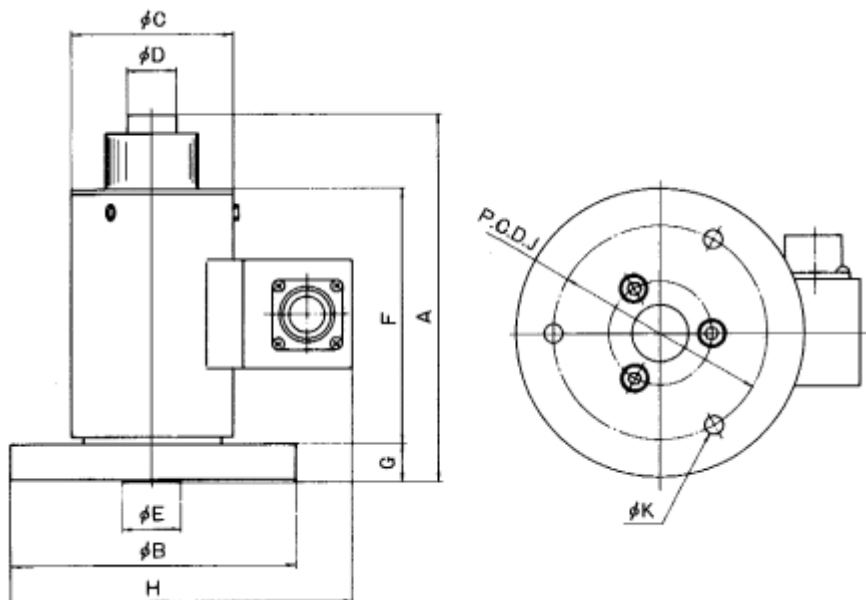

Model and Capacity / Dimension / etc. (unit : mm)

Model	Capacity	A	B	C	D	E	F	G	H	J	K	Natural frequency	Weight
RC-10KN	10kN	102	80	45	14	18	87	10	94.5	60	3- Φ5.5	1.3kHz	1.4kg
RC-20KN	20kN	102	80	45	14	18	87	10	94.5	60	3- Φ5.5	5.4kHz	1.4kg
RC-50KN	50kN	110	80	40	20	15	95	10	93	65	4- Φ6.5	9.0kHz	1.6kg
RC-100KN	100kN	120	100	50	30	21	105	10	108	80	4- Φ8.5	8.3kHz	2.0kg
RC-200KN	200kN	150	120	66	40	30	134	11	126	100	4- Φ8.5	8.1kHz	3.28kg
RC-500KN <sup>※1</sup>	500kN	210	150	98	60	48	185	20	157	125	4- Φ10.5	4.8kHz	13kg
RC-1MN <sup>※1</sup>	1MN	276	250	143	100	68	245	21	225	190	4- Φ13.0	3.7kHz	30kg
RC-2MN <sup>※1</sup>	2MN	331	280	170	130	95	297	25	255	220	4- Φ13.0	3.7kHz	46kg
RC-5MN <sup>※1</sup>	5MN	430	380	242	200	150	383	37	348	320	4- Φ15.5	2.9kHz	122kg

- \* Confirmation to undescribed items to be made with reference to descriptions on instruction manuals or directly to this Company.
- \* Items with Marks (※1) are produced only on order placed.

## Specifications

Safe Overload	150%RC
Rated Output	1.5mV/V±1%
Nonlinearity	0.2%RO
Hysteresis	0.2%RO
Repeatability	0.1%RO
Excitation Voltage	12V (or less)
Safe Excitation Voltage	20V
Input Resistance	350Ω
Output Resistance	350Ω
Compensated Temp.Range	-10 to 60°C
Safe Temp.Range	-30 to 80°C
Temp.Effect on Zero	0.01%RO/°C
Temp.Effect on Output	0.01%/°C
Connector(on body)	Receptacle / PRC03-21A10-7F
Attached cable	L-A-5 ( <a href="#">Refer to transducer connections</a> )